

INSTRUCTIONS FOR USE Asenapine Sublingual Tablets

Read these Instructions for Use before you start using asenapine sublingual tablets and each time you get a refill. There may be new information. This leaflet does not take the place of talking to your doctor about your medical condition or your treatment.

IMPORTANT:

- **For sublingual (under your tongue) use only**
- **Do not remove tablet until ready to administer.**
- **Use dry hands when handling tablet.**

Directions for Taking your Asenapine Sublingual Tablets:

Step 1. Hold the blister as such that it faces the printed blister foil side and tear along the perforation marked on the blister to separate.

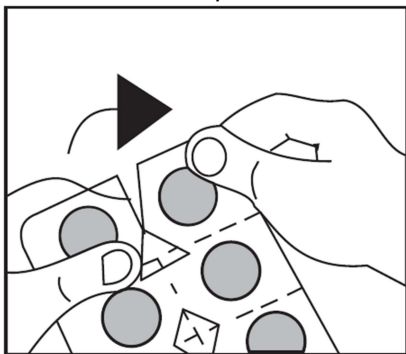

Figure A

Step 2. Peel the paper where “PEEL & PUSH” is given on the blister to expose foil.

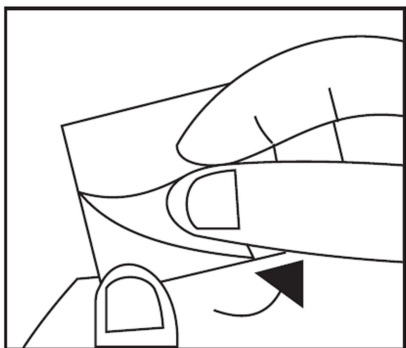

Figure B

Step 3. Gently PUSH tablet through foil and take the tablet (see Figure C).
Do not split, cut or crush the tablet.

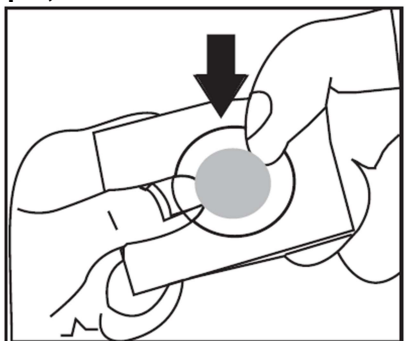

Figure C

Step 4. Place the **whole** tablet **under** tongue and allow it to dissolve completely (see Figure D).

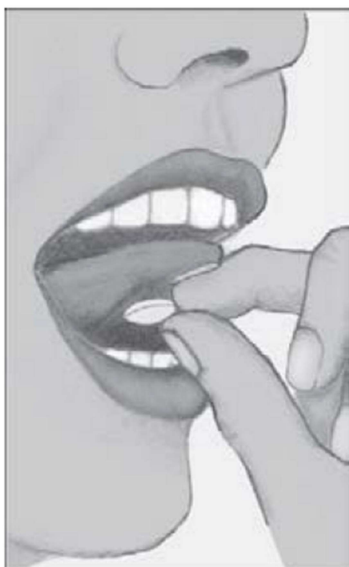

Figure D

Do not chew or swallow the tablet.

Do not eat or drink for 10 minutes (See Figure E).



Figure E

Storing asenapine sublingual tablets:

Store asenapine sublingual tablets at room temperature between 68°F to 77°F (20°C to 25°C).

These Instructions for Use have been approved by the U.S. Food and Drug Administration.

Manufactured by:
MSN Laboratories Private Limited
Telangana- 509 228, INDIA.

Distributed by:
Breckenridge Pharmaceutical, Inc.
Berlin, CT 06037

Revised: 07/2020